

656027, Chair, Beach, 3D

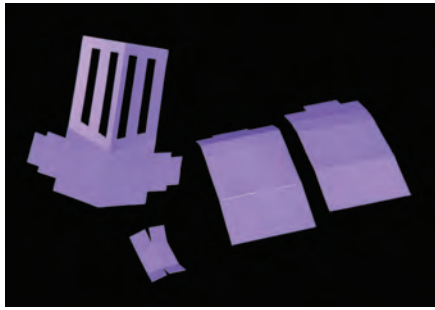

1. Die-cut Chair pieces and fold along crease lines.

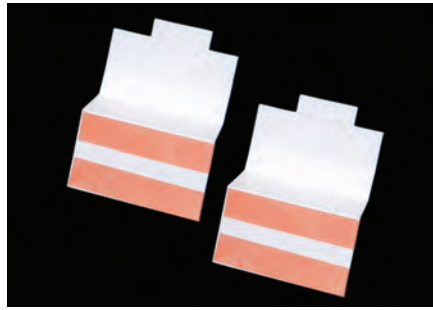

2. Attach strong double-sided adhesive to the base tabs of the Chair side pieces.

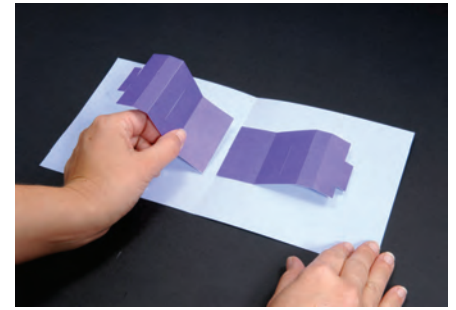

3. Adhere side pieces to card so the base tabs meet at the crease.

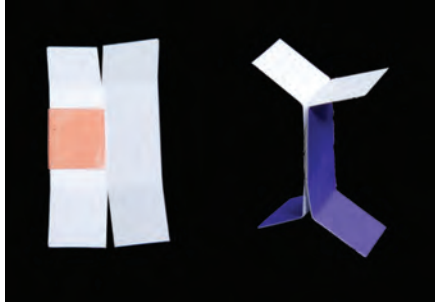

4. Create the center column by placing double-sided tape on one side of the middle section and then folding it closed.

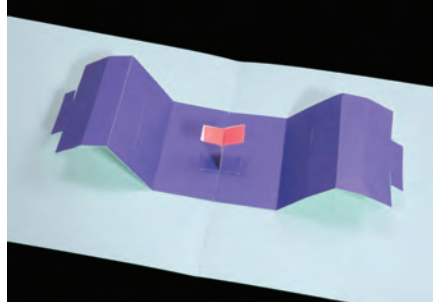

5. Using double-sided tape, attach the center support 3/4" from the front of the Chair with the flaps straddling the card crease. Add a strip of adhesive to the top flaps of the column. (Note: The column location controls the Chair back's angle of recline. For a more vertical position, move the column closer to the front of the Chair; for greater recline, move the column back.)

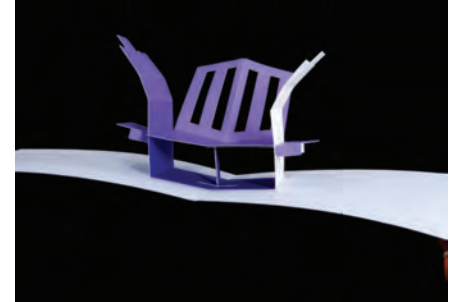

6. Fold the locking flaps and the chair seat tabs and insert them into the large slots of the chair arms until they stop. Open the locking flaps. Attach the column to the bottom of the seat so that the flaps straddle the center crease.



7. Fold the locking flaps on the chair arms and insert them into the slots of the chair seat tabs until they stop, then unfold the locking flaps. (This may require a pair of tweezers.)

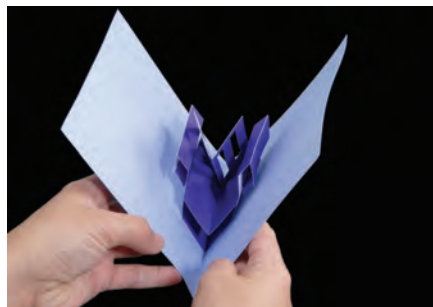

8. Close the card, pulling up on the seat back as necessary to train it to fold inward.

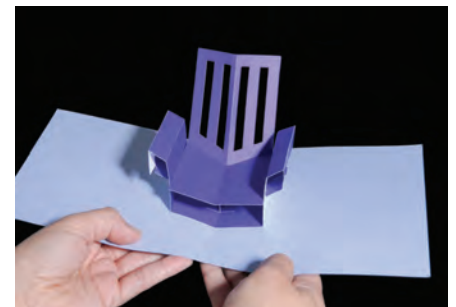

9. The Chair is assembled.