

656999 Sizzix® Bigz™ Die - Pull Tag Frame, 3-D (Pop-Up) by Karen Burniston

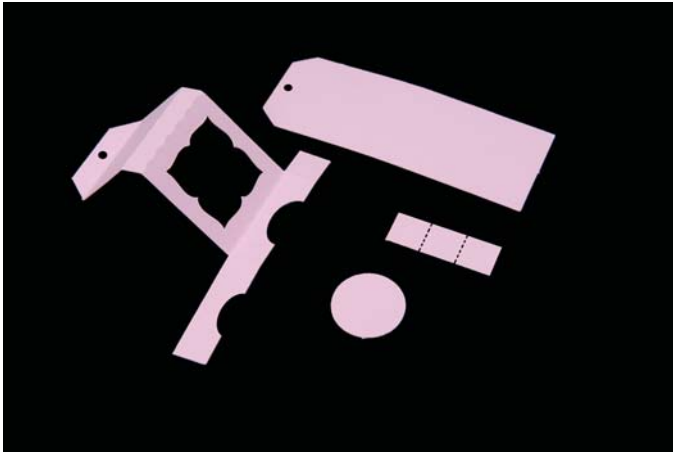

1. Die-cut and fold pieces as shown.



2. Flip the frame piece over and create the sleeve by attaching the small tab to the large tab with a strong adhesive.



3. Attach the frame piece to the top of the Pull Tag by using a strong adhesive in the uppermost panel of the frame piece, no lower than the first fold, and then aligning the holes at the top.

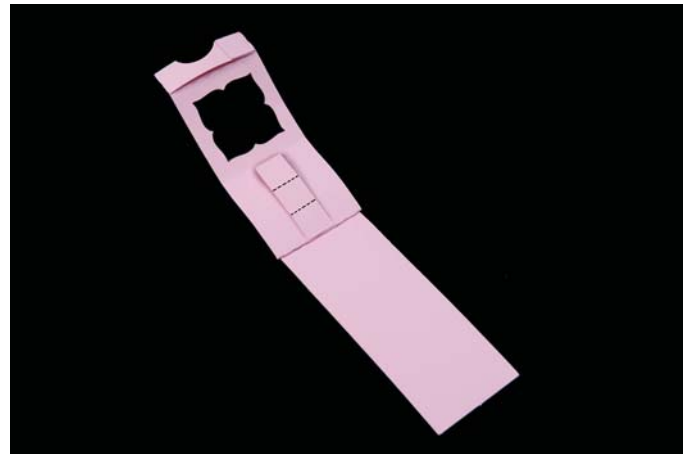

4. Lift the frame piece all the way open and attach the bottom panel of the pop-up strip to the square indicated with perforations.

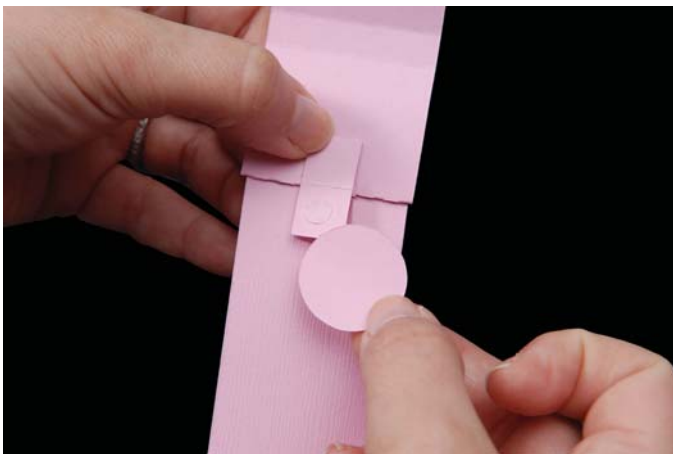

5. Fold over the pop-up strip on the next fold and adhere the pop-up shape to the end panel of the pop-up strip.



Your pop-up should appear as shown.

656999 Sizzix® Bigz™ Die - Pull Tag Frame, 3-D (Pop-Up) by Karen Burniston



6. Slide the Pull Tag through the sleeve.



7. Make sure that when the Pull Tag is in the closed position, the pop-up is facing down.



8. When you pull on the Pull Tag, the frame and the pop-up should align as shown.