

658424 Sizzix® Bigz™ XL - Birdhouse, Rounded, 3D by Susan Tierney Cockburn

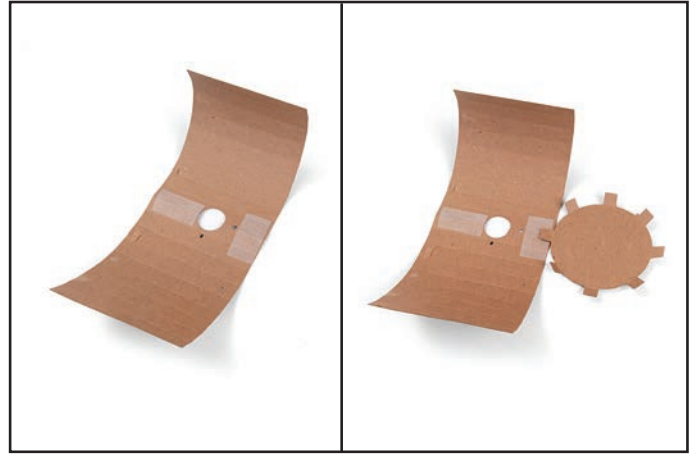

1. Die-cut material and apply adhesive as shown.



2. Align the entrance hole edges of the Birdhouse body and connect them using single-sided tape. Attach one of the bottom piece tabs over the joint as shown.

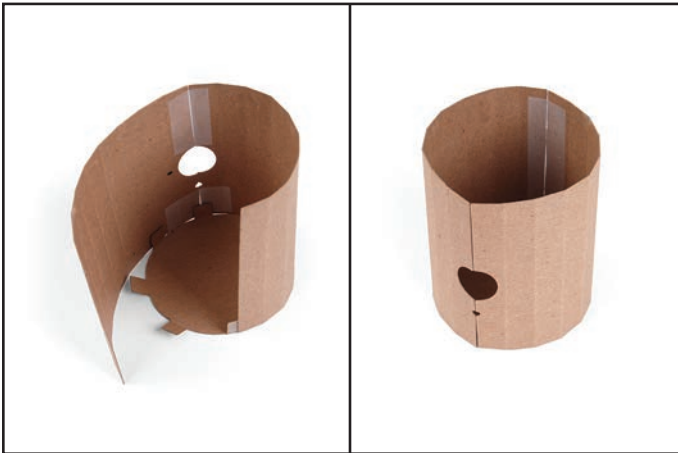

3. Wrap the sides of the birdhouse around the bottom while adhering each of the bottom tabs. Use single-sided tape to finish the seam where the two sides meet in the back.

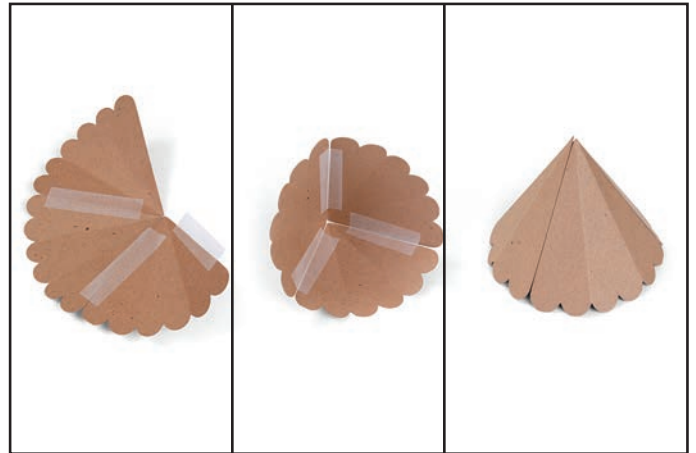

4. Connect the three roof pieces together using single-sided tape.



5. Apply adhesive to the top of the Birdhouse body and adhere the roof to the body.



6. Adhere the roof cap to the point of the roof and embellish as desired.